

WALL FINISHES - TECH SHEET

SOLID WALL (FACE PANELED WALL)

V2 LOW PROFILE BASE

build better™
DIRTT

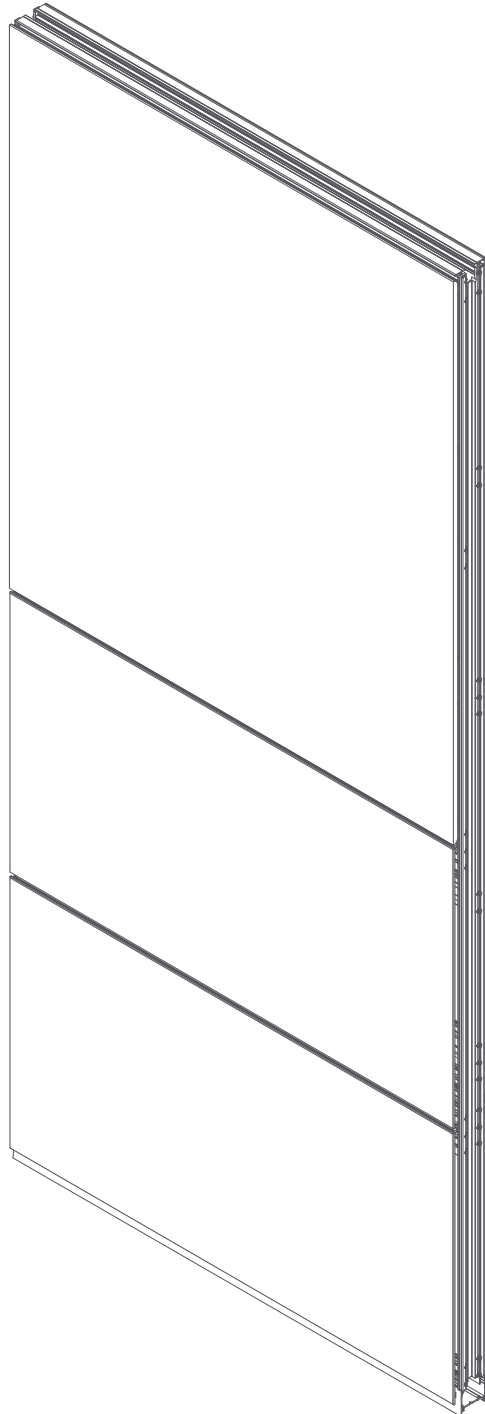

COMPONENTS AND MATERIALS

ALUMINUM EXTRUSIONS

Architectural Grade and Structural Aluminum Alloys
Vertical and Horizontal Extrusions, Base Track

HORIZONTAL SECTIONS

Partially exposed Horizontal Support Member for dividing panels and hanging components; heights user defined.

Hidden Horizontal Member for additional support of face mounted panels; heights user defined as required.

INSULATION

1" (25mm) thick Insulation, factory installed in frame.

Base Insulation to be field installed in base cavity prior to base trim or scribed panels.

BASE TRACK

Aluminum Base Track
Steel Leveler Assembly with vertical adjustment
Carpet Grippers
Optional Two-sided Tape for smooth flooring
Optional Seismic BaSolise Track

BASE TRIM

Santoprene Base Trim
Oversized Solid Panels scribed to floor on site

FACE MOUNT PANEL OPTIONS

Chromacoat (painted) Panels
ChromacoatPlus Panels
Thermofoil Panels
Wood Veneer on MDF Panels
Willow® Glass on MDF Panels
Micro Perforated Wood Veneer on MDF Panels
Magnetic Marker Board Panels
Marker Board Panels
Fabric Panels (tackable and non-tackable)
Frameless Backpainted Glass Panels
Slat Wall Panels (Accessory Rail)
DIRTT Approved Custom Finishes

PVC COMPONENTS

Frame Connections	Rigid/Flex Co-extrusion
Ceiling Trim/Wall Start	Rigid/Flex Co-extrusion
PVC Color Options	Black, Charcoal, Silver, Custom as required

ELECTRICAL COMPONENTS

120/208V 20A (15A Canada)
Maximum of 30 Wall Boxes per Frame
UL/CSA Listed Wall Boxes and Devices
Level 3 Wall Boxes UL/CSA Listed AC/MC Cable
Level 4 Wall Boxes Connect to Splitters, Extender Cables,
Express Lines, Whips, Zone Boxes in
Ceiling or Wall

DIMENSIONS AND DETAILS

FRAME

Standard Wall Thickness	4" (102mm) with Panels
Minimum Module Width	6" (152mm)
Maximum Module Width	48" (1219mm)*

**NOTE: Frame assemblies exceeding 48" (1.22m) in width or 144" (3.66m) in height, or both must be validated by DIRTT to confirm walls do not exceed the maximum allowable deflection per International Building Code (IBC).*

Standard Ceiling Height	Up to 144" (3.66m)
Vertical Height Adjustment - V2 Base	-3/8" (-9.5mm) and +2 5/8" (+67mm)**

***NOTE: This adjustability range is only achievable with the solid frame. DIRTT standard for maximum adjustment range in its wall system is +1 3/8" (+35mm). Related components (e.g., posts, door frames or doors) do not share the same amount of adjustability. Consequently, they may not be aligned when using the maximum adjustment range.*

FRAME CONNECTIONS

Hidden Links	Frame alignment and gap control
Visible PVC Zipper	At frame connection between frames

TRIM COMPONENTS

Ceiling Trim	Flexible trim from top of wall to ceiling
Wall Trim	Rigid connection from Frame to Base Building; combined with flexible Wall Trim

OTHER COMPONENT CONNECTIONS

Glass Panels
Door Frames
Corner Connectors
Various Base Building Connections
Modular and Conventional Electrical

OTHER OPTIONS

Combination Wall	Solid Wall with Glass Wall
Curtain Wall	Installed in front of base building with panels on one side only

Low Wall
Cornice Height Wall
Center Steel Septum
Mitered Corner Joint
Extended Levelers for additional leveling capability
Seismic
Enhanced STC Performance
DIRTT Approved Custom Solutions (Bespoke)
NAUF/NAF MDF
Fire Retardant MDF

TESTING AND APPROVALS

Code Compliance Research Report	CCRR-1012
Transverse Load	ASTM E72
Flame Spread	ASTM E84
STC Rating 37-50	ASTM E90 (Dependent on wall construction)
Wall Electrical	UL 468975 (Sections and Units)
OSHPD	OPM-0044-13
Seismic Engineering Calculations	
Seismic Bracing Details	

NOTE: Testing Reports, Details and Approvals are available upon request.

ISOMETRIC/WALL STRUCTURE

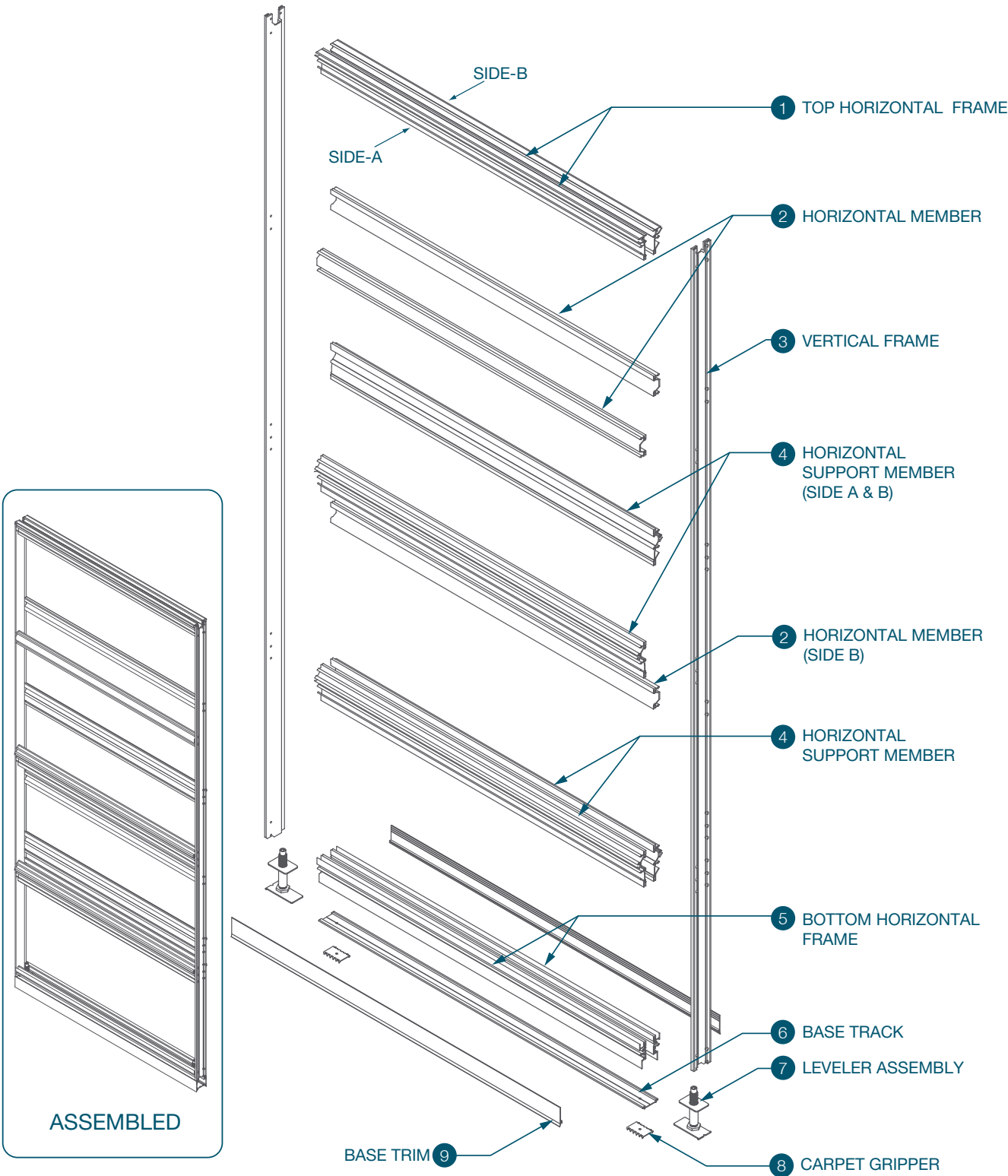

ISOMETRIC / WALL PANEL

